



UBP054 Ford Ranger PX, PX II, Everest, Mazda BT50 2011+ Underbody Protection.
Engine Type: 3.2L Diesel (4WD)

UNDERBODY PROTECTION:

These protection plates have been designed for installation for the intended application only. They should be mounted according to these installation instructions by an experienced Ironman 4x4 dealer or certified fitter. The plates are fixed to original vehicle mountings located on the vehicle's body load-bearing elements. Upon successful installation the plate should not interfere with any other parts or components.

Ironman 4x4 recommend the use of a floor or transmission jack to assist with the installation of underbody protection plates.

INSTALLATION:

1. Remove original engine / transmission protection plates
2. Remove bolt from transfer case protection plate located nearest to centre of vehicle and loosen outer most bolt. (Retain bolt for later use). Refer Fig 1.
3. Install 'lollypop' fastener into cross member and install rear plate mount to cross member ensuring plate is positioned between cross member and transfer case protection plate.
4. Re-install bolt to transfer case protection plate.
5. Position rear plate and loosely thread all fasteners into place and tension after aligning. Refer illustration.
6. Position mid plate and loosely thread all fasteners into place before tensioning including fasteners joining front and rear plates. Refer illustration.

NOTE: Repeat step 6 for the front plate.

***NOTE:** Only use spacers provided if fitting to vehicle with standard bumper bar.

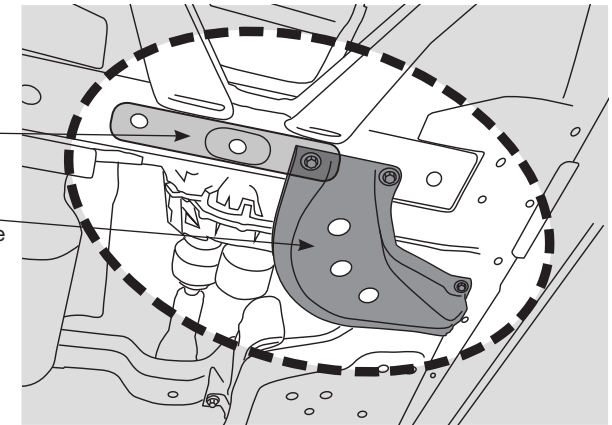
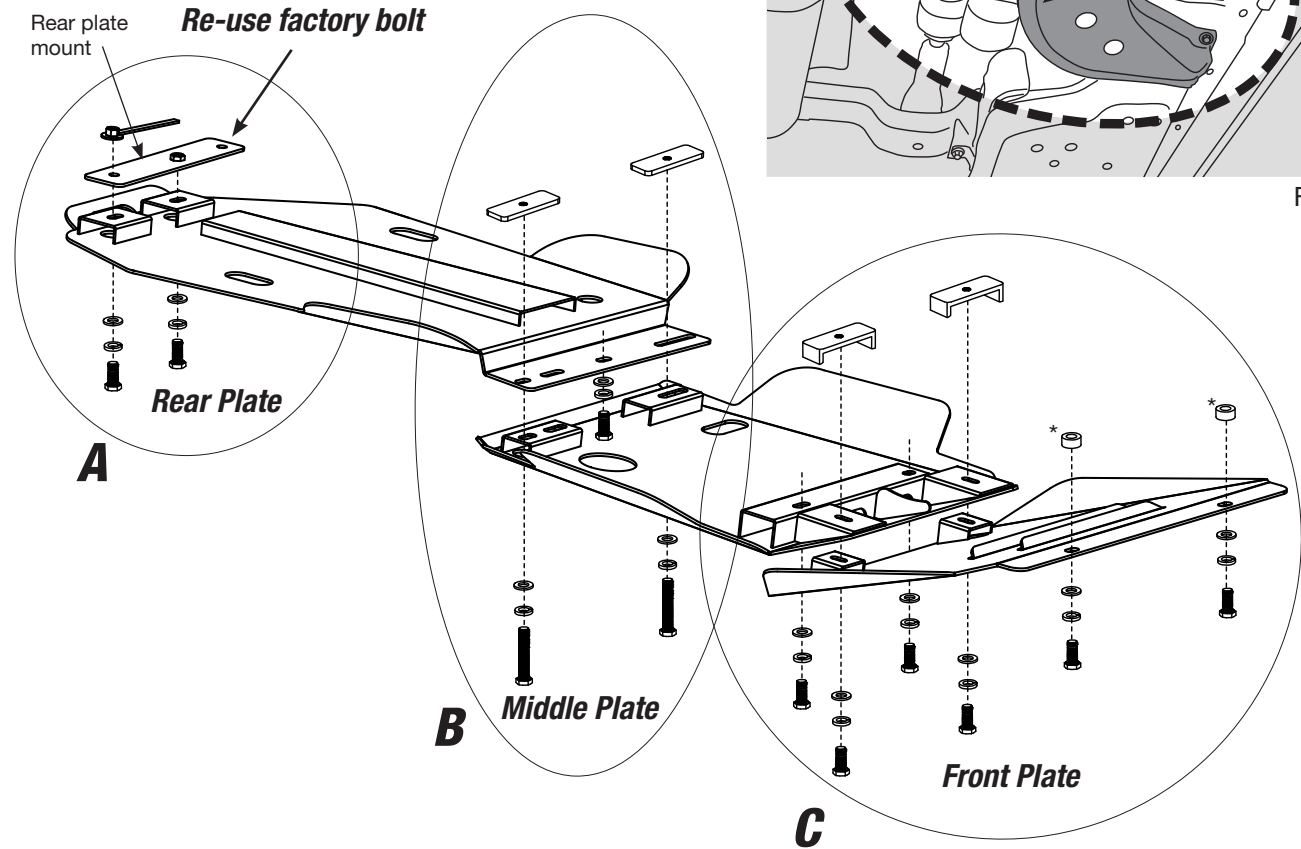

Fig 1



WARRANTY: 2 years.

Thread:	M10x1.5
Tightening Torque:	52.0Nm

WARRANTY TERMS:

The plate should only be installed on a vehicle with undamaged body and load-bearing elements, vehicles which have been involved in a significant collision may prevent successful installation.

A

Lollypop Qty: 1
 Bolt M10 x 45 Qty: 2
 Spring Washer M10 Qty: 2
 Flat Washer M10 Qty: 2

B

Bolt M10 x 80 Qty: 2
 Spring Washer M10 Qty: 3
 Flat Washer M10 Qty: 3
 Bolt M10 x 45 Qty: 1
 Threaded Plate Qty: 2

C

Bolt M10 x 45 Qty: 6
 Spring Washer M10 Qty: 6
 Flat Washer M10 Qty: 6
 Threaded Bridge Qty: 2
 Spacers Qty: 2